

UNITED LAGUNA WOODS MUTUAL

Section 42 - Solar Panels, 2 Story Buildings with Flat Roofs

ADOPTED OCTOBER 2014, RESOLUTION 01-14-130
GENERAL REQUIREMENTS REVISED JANUARY 2016, RESOLUTION 01-16-08

1.0 GENERAL REQUIREMENTS

- 1.1 **PERMITS AND FEES:** A Mutual consent for Manor Alterations is required for all alterations to the building. A City of Laguna Woods permit may be required. All fees for both Mutual and City permits shall be paid for by the Member and/or his or her contractor. Member and/or his or her contractor must provide the Manor Alterations Department office with City permit number(s) prior to beginning work.
- 1.2 **MEMBERS' RESPONSIBILITY:** The Member is solely responsible for the maintenance, repair, and/or removal of all alterations to the building.
- 1.3 **CODES AND REGULATIONS:** All work shall comply with all applicable local, state, and federal requirements including, but not limited to, the current edition of the National Electric Code (NEC).
- 1.4 **WORK HOURS:** Contractors working for residents at individual manors and in carports are permitted to work from 9:00 AM – 5:00 PM Monday through Friday. No work whatsoever shall be permitted on Saturday and Sunday, and construction is restricted to 6 months out of every 12 months of the year.
- 1.5 **PLANS:** The Member applying for a Mutual Consent for Manor Alteration(s) shall provide to the Manor Alterations Department a detailed plan(s) for approval indicating all work to be done, i.e., size, location, description and specifications.
- 1.6 **DUMPSITES:** The premises shall be kept free of accumulation of waste materials and/or rubbish caused by construction work. The Member and/or his or her contractor are responsible for removal of debris and excess material and must leave work areas "**BROOM CLEAN**" daily. **USE OF COMMUNITY DUMPSITES FOR CONSTRUCTION RELATED DUMPING IS NOT PERMITTED.**

Contractor's or Member's dumpsters, if required, must have location approved by the Manor Alterations Department.

- 1.7 **CONTRACTOR:** Installation must be performed by a California licensed contractor of the appropriate trade.
- 1.8 **CONTRACTOR'S CONDUCT:** Member's contractor's, their personnel, and sub-contractors shall refrain at all times from using profanity, abusive or loud language, and must wear shirts at all times. Radio, MP3, CD or cassette players are not permitted on the project site. Contractor personnel will, at all times, extend and exhibit a courteous demeanor to residents.

2.0 **APPLICATIONS**

- 2.1 Leasing of solar panels for installation on United Mutual manors is strictly prohibited.
- 2.2 In this section, Solar Panel refers to roof mounted panels that use solar energy to either heat water directly (Solar Water Heating System), or to generate electricity using photo-voltaic cells (Solar Electric System).
- 2.3 This section refers to two story dwellings with shared flat roof space. The system shall be designed so the panel array does not encroach outside of the area allocated on the roof for each owner of a manor. Refer to Pages 5, 6, 7 and 8 for roof allocation on flat roofs of 6-, 8-, and 12-unit buildings respectively.
- 2.4 Detailed, site-specific plans, including for all water and electrical lines for the solar panel installation, including penetrations, shall be submitted to the Manor Alterations Department for approval.
- 2.5 Detailed plans of the installation of roof jacks should be submitted to the Manor Alterations Department for approval, and installation of roof jacks, including hot mopping and flashing, is required to be completed during the original installation.
- 2.6 Regardless of the roof type, all tie-ins must be performed by the Mutual's roofing contractor at the Member's expense.
- 2.7 Water and electric lines must be set on blocking above the surface to facilitate re-roofing.

- 2.8 Structural calculations for the existing roof structure, signed and wet-stamped by a California-licensed structural engineer are required to ensure the solar panel system does not compromise the existing roof structure and that the roof is adequate to accept attachments and to support all applied loadings, per the California Building Code.
- 2.9 The mounting system must have a current Engineering Certification that certifies the system will be structurally adequate and satisfy building codes when installed per the instructions.
- 2.10 The solar panel array must be located a minimum of 3 feet from the edge of the roof; and a minimum of 3 feet shall be maintained between rows of solar panels, and between any architectural features such as, but not limited to skylights, mechanical equipment, and vent pipes in order to enable proper access for maintenance.
- 2.11 The solar panel array cannot be installed over any existing Mutual component or Member alteration.
- 2.12 Flat roof mounting shall be set with the highest point flush with the top of the parapet wall so as to be hidden from the ground or surrounding properties.
- 2.13 Lag screws must have adequate pullout strength and shear capacities.
- 2.14 The waterproof integrity of the roof, including the selection and use of appropriate flashing and sealers, must be maintained.
- 2.15 Solar Electric Panels, and their associated electrical components, must be UL listed, or comply with equivalent international standards.
- 2.16 All work must comply with the California Building Code.
- 2.17 The use of solar micro-inverter or power optimizer technology is required due to the potential number of separate systems that could be installed on one building.

3.0 OBLIGATIONS

- 3.1 Member agrees to pay for repairs to roof that may be attributed to damage caused by contractors installing or servicing solar panels if manifested within 5 years of installation or servicing of solar panels.

- 3.2** The Mutual Member is responsible for, and will bear all costs associated with removing, altering, covering or replacing the alteration as may be necessary or appropriate to allow the corporation business.
- 3.3** The Mutual Member is responsible for, and will bear all costs associated with, clean-up or repair of mutual owned or controlled property made necessary by or resulting from the alteration.
- 3.4** All costs associated with roof replacement above and beyond the typical cost for roof replacement due to the solar panel installation shall be borne by the Member(s).

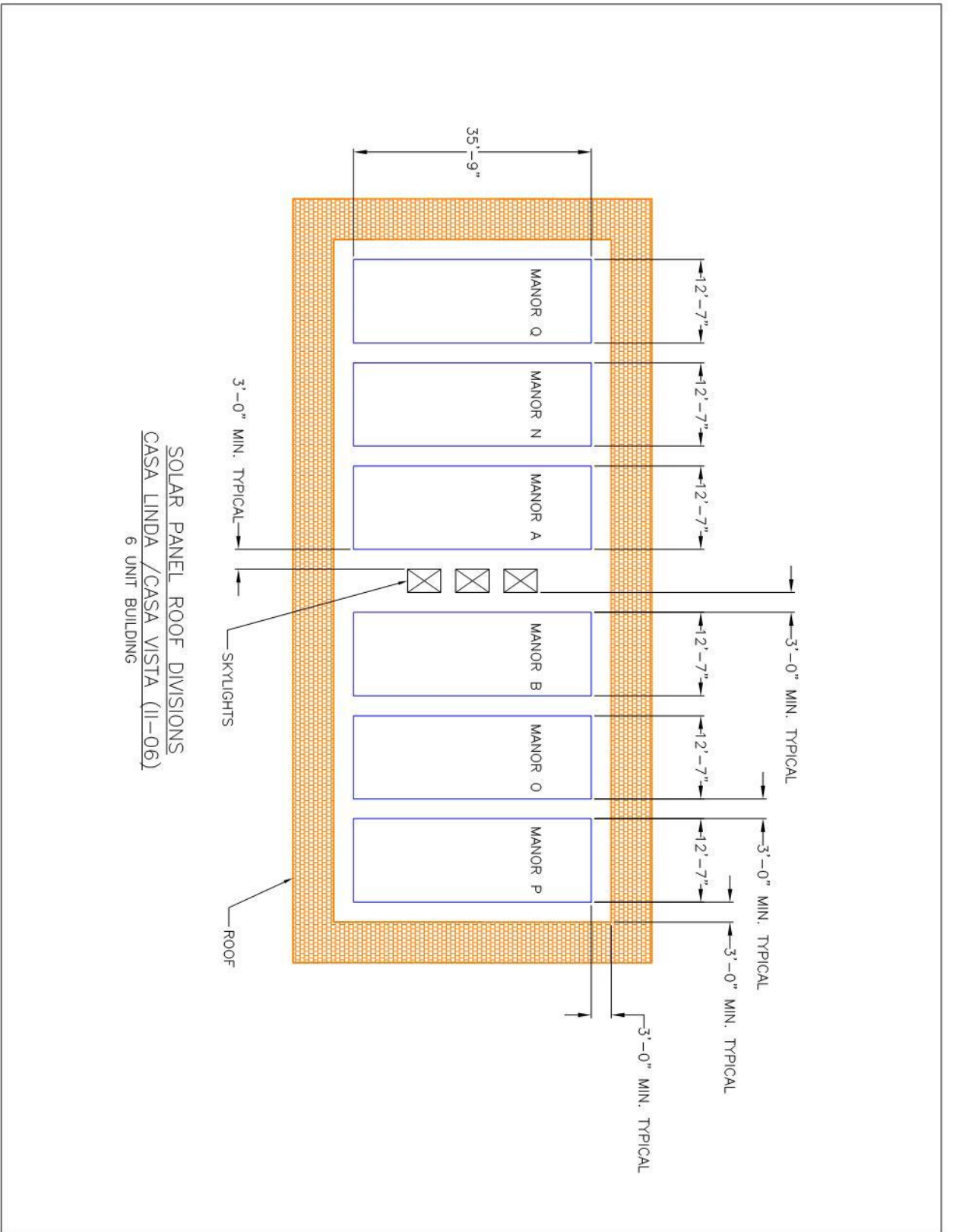

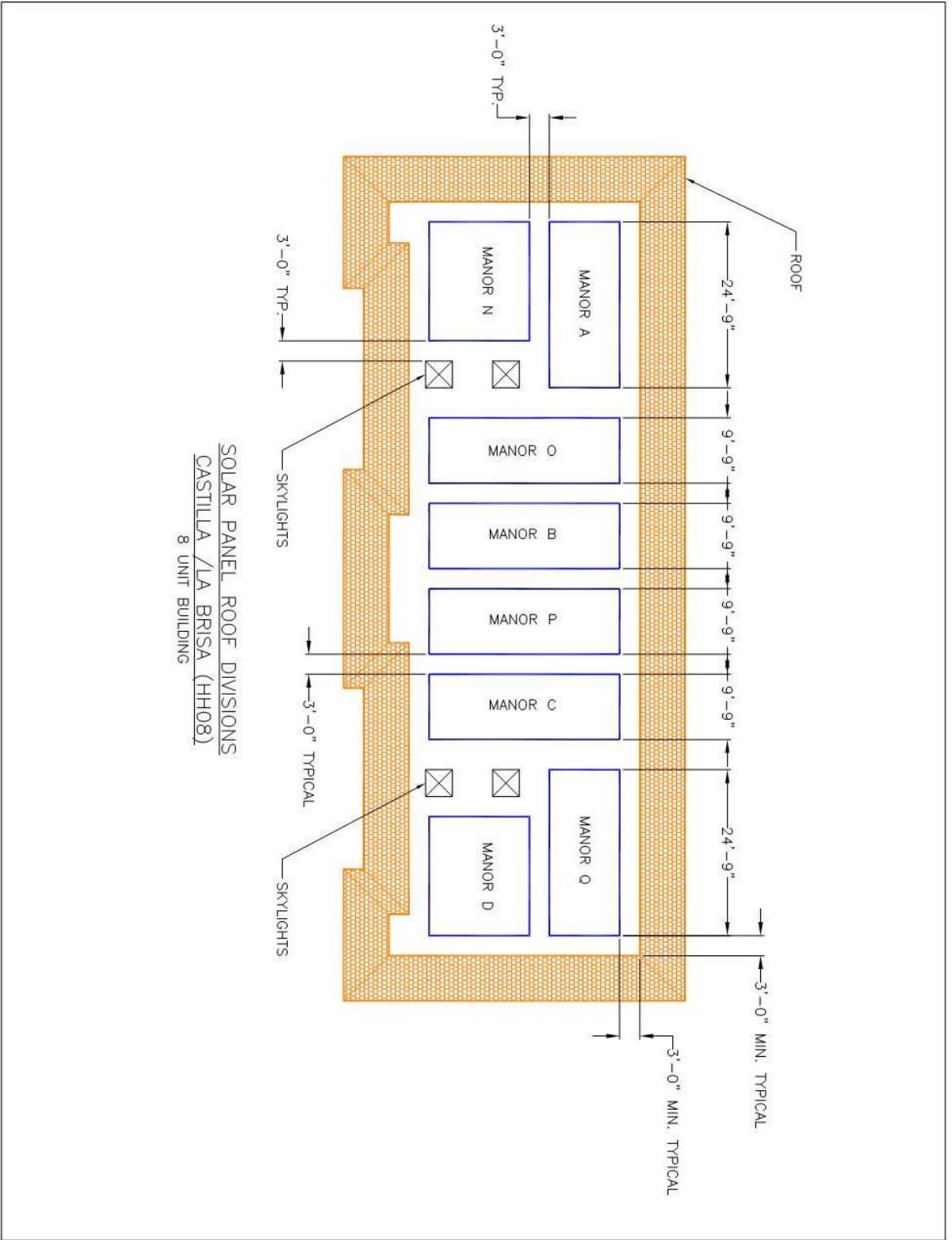

SOLAR PANEL ROOF DIVISIONS
 CASTILLA /LA BRISA (HH08)
 8 UNIT BUILDING

