

SECTION 'A'
SCALE 3/8" = 1'-0"

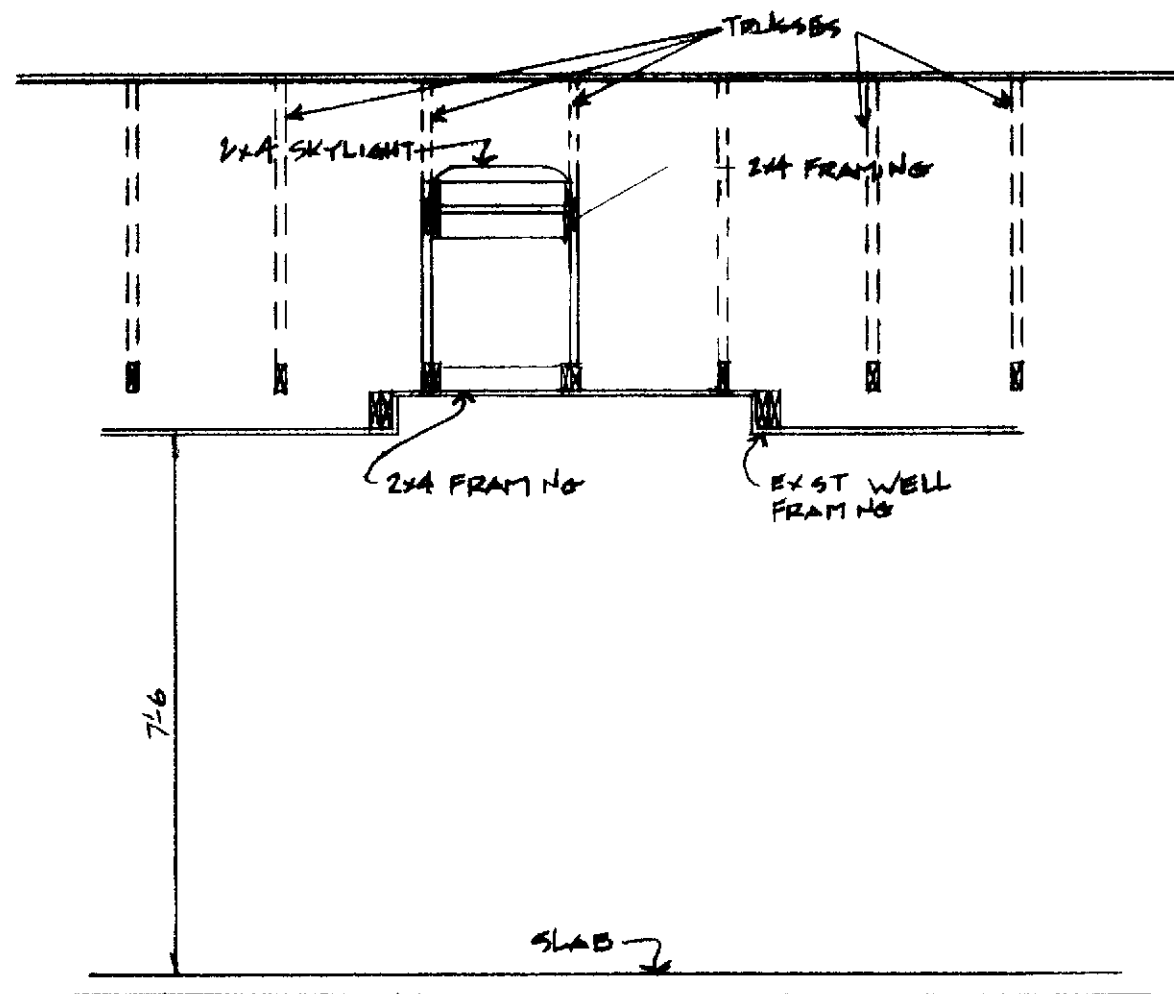

SECTION B
SCALE 3/8" = 1'-0"

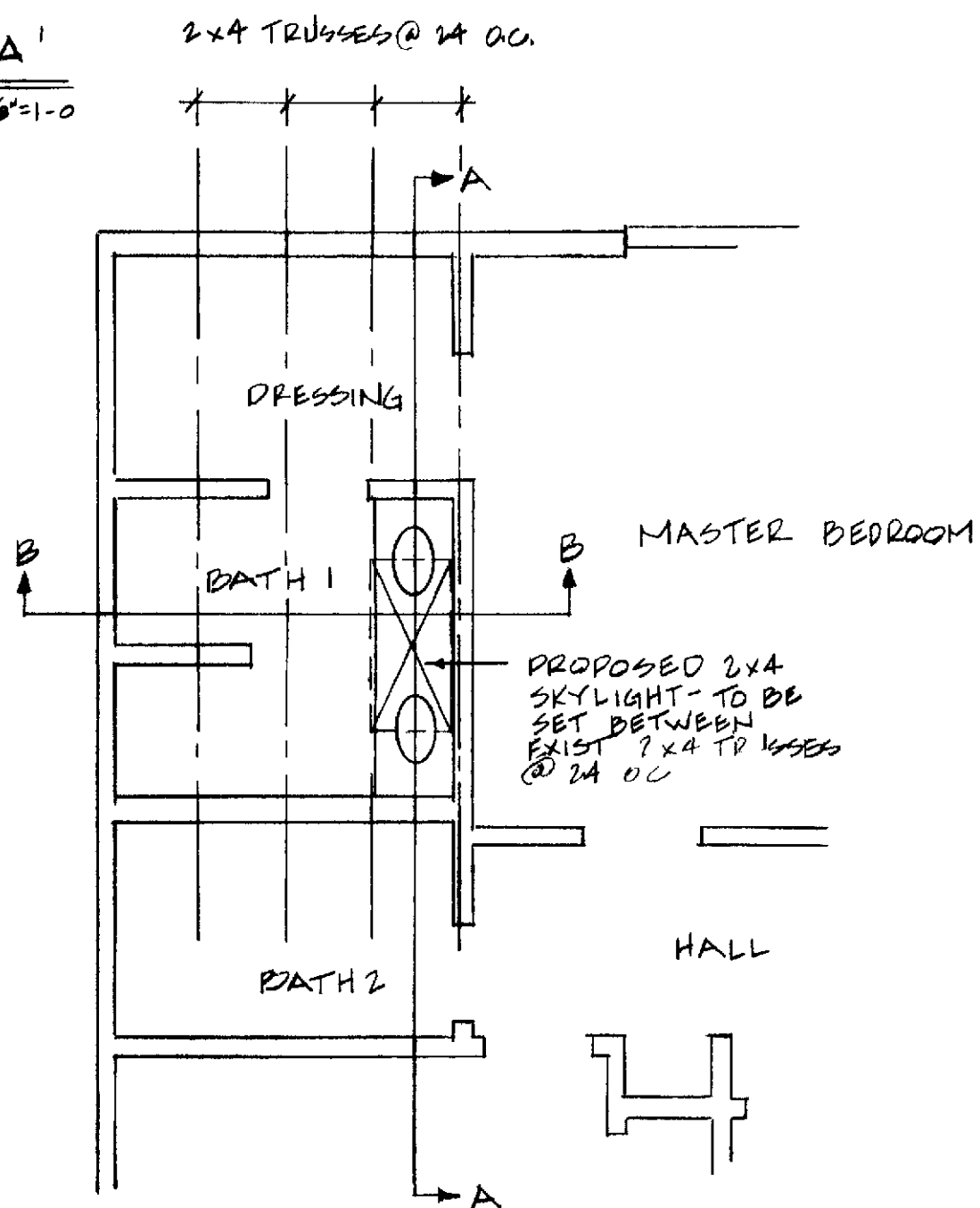

PARTIAL FLOOR PLAN
SCALE 1/4" = 1'-0"

TOTAL SQUARE FOOTAGE	2066
ALLOWABLE WINDOW AREAS	413
WINDOW AREAS BEFORE PROPOSED SKYLIGHT	204
2x4 SKYLIGHT	8
TOTAL WINDOW SQ FTG	212

GENERAL NOTES

- 1 DIMENSIONS HAVE PREFERENCE OVER SCALE
- 2 CONTRACTOR SHALL VERIFY ALL DIMENSIONS AND CONDITIONS PRIOR TO ANY WORK
- 3 CONTRACTOR SHALL SECURE & PAY FOR ANY & ALL PERMITS REQ'D BY P.C.M. & BY THE O.C. BLDG DEPT
- 4 ALL PHASES OF CONSTRUCTION SHALL COMPLY WITH CURRENT ED U.B.C. AND/OR STATE AND LOCAL CODES
- 5 UPON COMPLETION OF WORK CONTRACTOR SHALL REMOVE ALL EXCESS MATERIAL AND LEAVE AREAS OF WORK DROOM CLEAN
- 6 ALL FASTENERS EXPOSED TO WEATHERING SHALL BE OF A NON-CORROSIVE OR GALVANIZED MATERIAL
- 7 FRAMING LUMBER - HORIZONTAL OF L#1 VERTICAL OF L#2 OR BETTER
- 8 LINE SKYLIGHT WELL W/ 5/8 DRYWALL AND TAPE ALL CORNERS AND JOINTS PAINT FLAT WHITE ALL INSIDE WELL
- 9 SKYLIGHT SHALL BE AN I.C.B.O. APPROVED ITEM WITH A MINIMUM CURB HEIGHT OF 6" AND NOT MORE THAN 6"
- 10 USE CLEAR SILICONE SEAL AT ALL FLASHING TO FLASHING, FLASHING TO CURB AND ALL POSSIBLE LEAK AREAS
- 11 FLASHING UNDER SHINGLE A MINIMUM OF 6"
- 12 SKYLIGHT TO BE I.C.B.O. #199B OR APPROVED EQUAL ONLY (PLASTIC)
- 13 NO SELF FLASHING SKYLITES ALLOWED NO EXCEPTIONS
- 14 ALL SKYLITES WILL BE FASTENED WITH CAP SCREWS NAILS ARE NOT PERMISSIBLE
- 15 ALL SKYLITES ARE REQUIRED TO HAVE A MINIMUM OF 5/2" CLEARANCE ABOVE THE ROOF

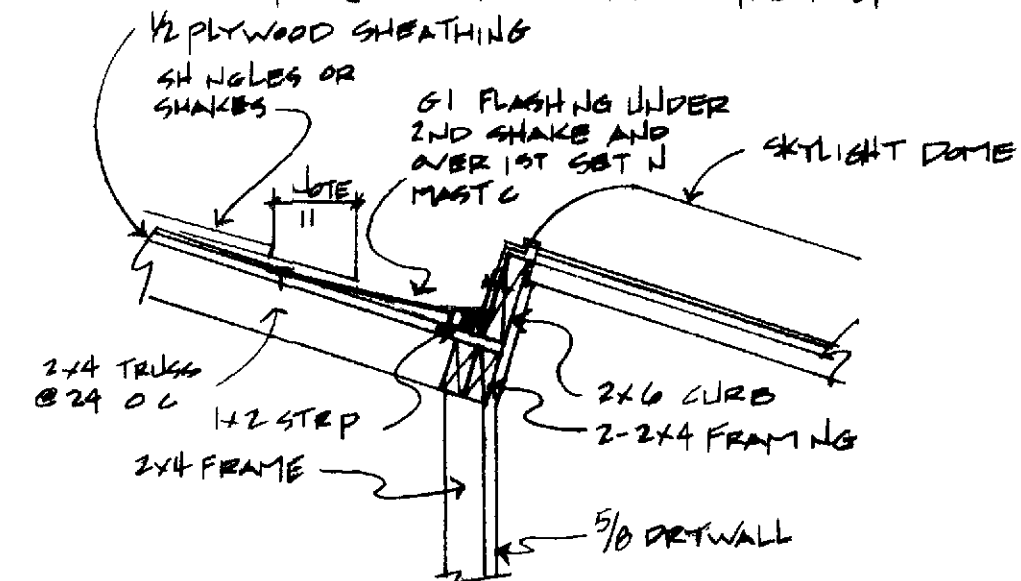

TYPICAL CURB DETAIL
SCALE 1/2" = 1'-0"

(76 563)

ANDALUZ - P43
SKYLIGHT - MASTER BATH

KEISURE WORLD
STANDARD PLAN
NUMBER - 207

PROFESSIONAL COMMUNITY MEETING
APPROVED

P.C.M. INC 380-4616
P.O. B 2220 LAGUNA HILLS

DATE 1-9-79

207