

NOTE LIMIT SIZE OF NEW PATIO COVER TO 180" OR LESS

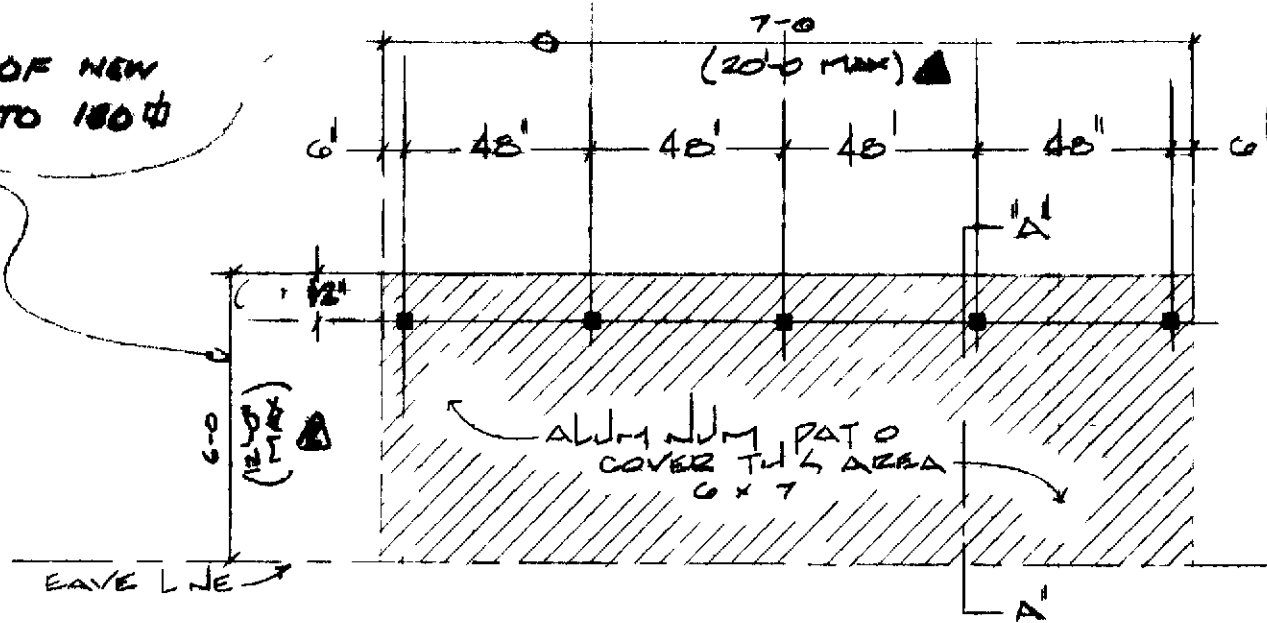

GENERAL NOTES UNLESS OTHERWISE SPECIFIED

- 1 DIMENSIONS HAVE PREFERENCE OVER SCALE
- 2 CONTRACTOR SHALL VERIFY ALL DIMENSIONS AND CONDITIONS AT EACH JOB SITE
- 3 ALL PHASES OF CONSTRUCTION SHALL COMPLY WITH THE CURRENT EDITION OF THE USC AND/OR STATE & LOCAL CODES
- 4 PATIO COVER - CANOPY SUPPORTING MEMBERS, GUTTER AND DOWNSPOUT SHALL BE ALUMINUM W/BALD ENAMEL FINISH
- 5 CONTRACTOR SHALL SECURE & PAY FOR ALL PERMITS REQUIRED BY THE LEISURE WORLD FOUNDATION AND THE ORANGE COUNTY DEPARTMENT OF BUILDING & SAFETY
- 6 UPON COMPLETION CONTRACTOR SHALL REMOVE ALL DEBRIS AND EXCESS MATERIAL AND LEAVE ALL AREAS OF WORK BROOM CLEAN
- 7 CONNECTION TO EXISTING CONSTRUCTION BASED UPON DESIGN LOADS AS FOLLOWS LL=10 PSF DL=2 PSF
- 8 ALUM FABRICATOR SHALL FURNISH BUILDING OFFICIAL WITH CALCULATIONS AND SHOP DRAWINGS SIGNED BY CIVIL OR STRUCTURAL ENGINEER LICENSED IN CALIFORNIA SUCH DESIGN SHALL INCLUDE BOTH VERTICAL LOADING AND LATERAL RESISTANCE.
- 9 ALT PLAN A IS FOR ANDALUZ AND CABRILLO MODELS OF CONVENTIONAL CONSTRUCTION ONLY DUE TO STRUCTURAL CALCULATIONS NOT USABLE ON MODULAR CONSTRUCTION LA REINA MODELS

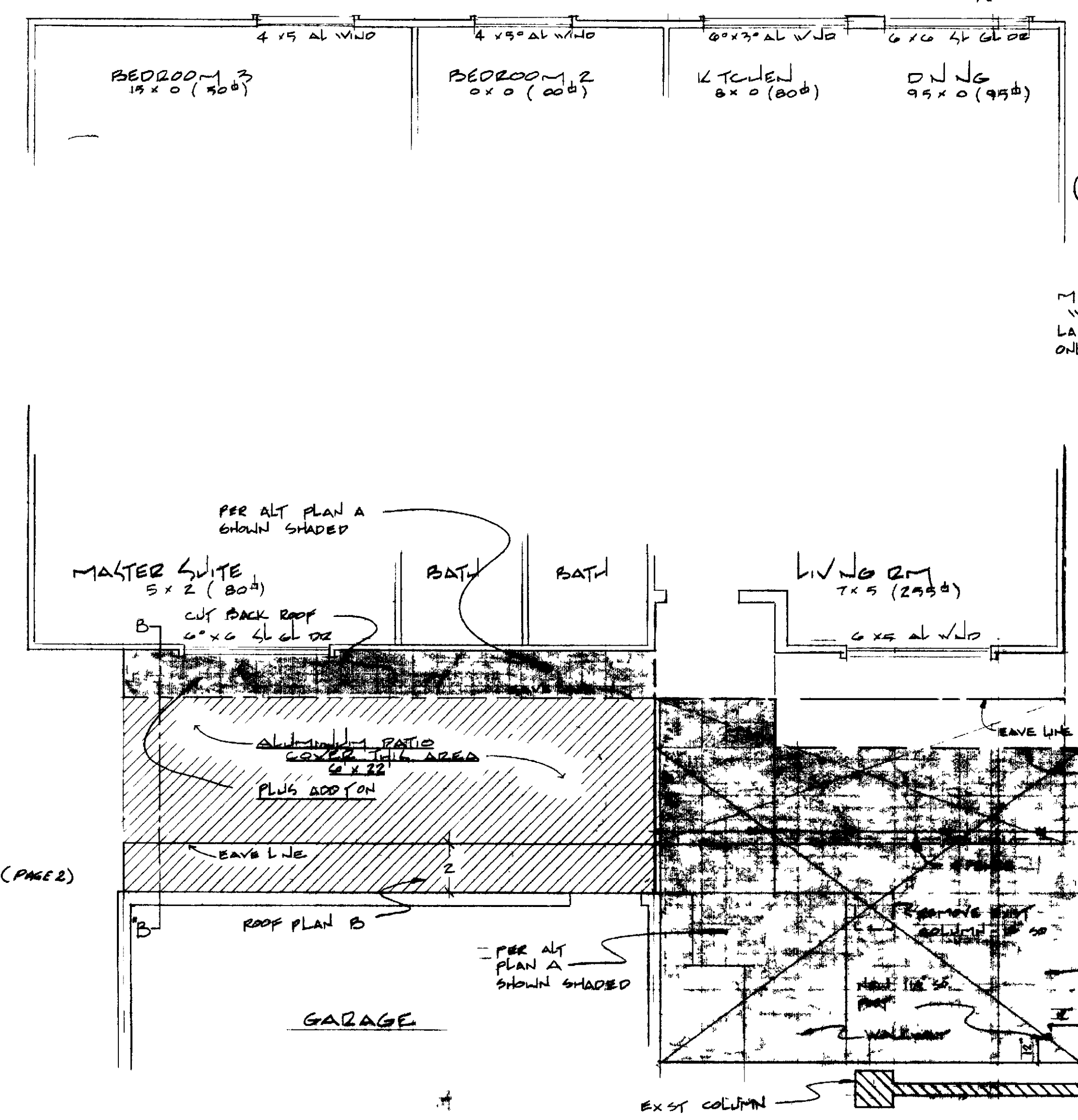

REV 8 3 73 - 2x4 TRUSS TAILOR MADE ALSO APPROXIMATE

(SEE STD PLAN TO 337 FOR COLCS)

MODULAR TYPE WALL PANEL LA REINA MODEL ONLY

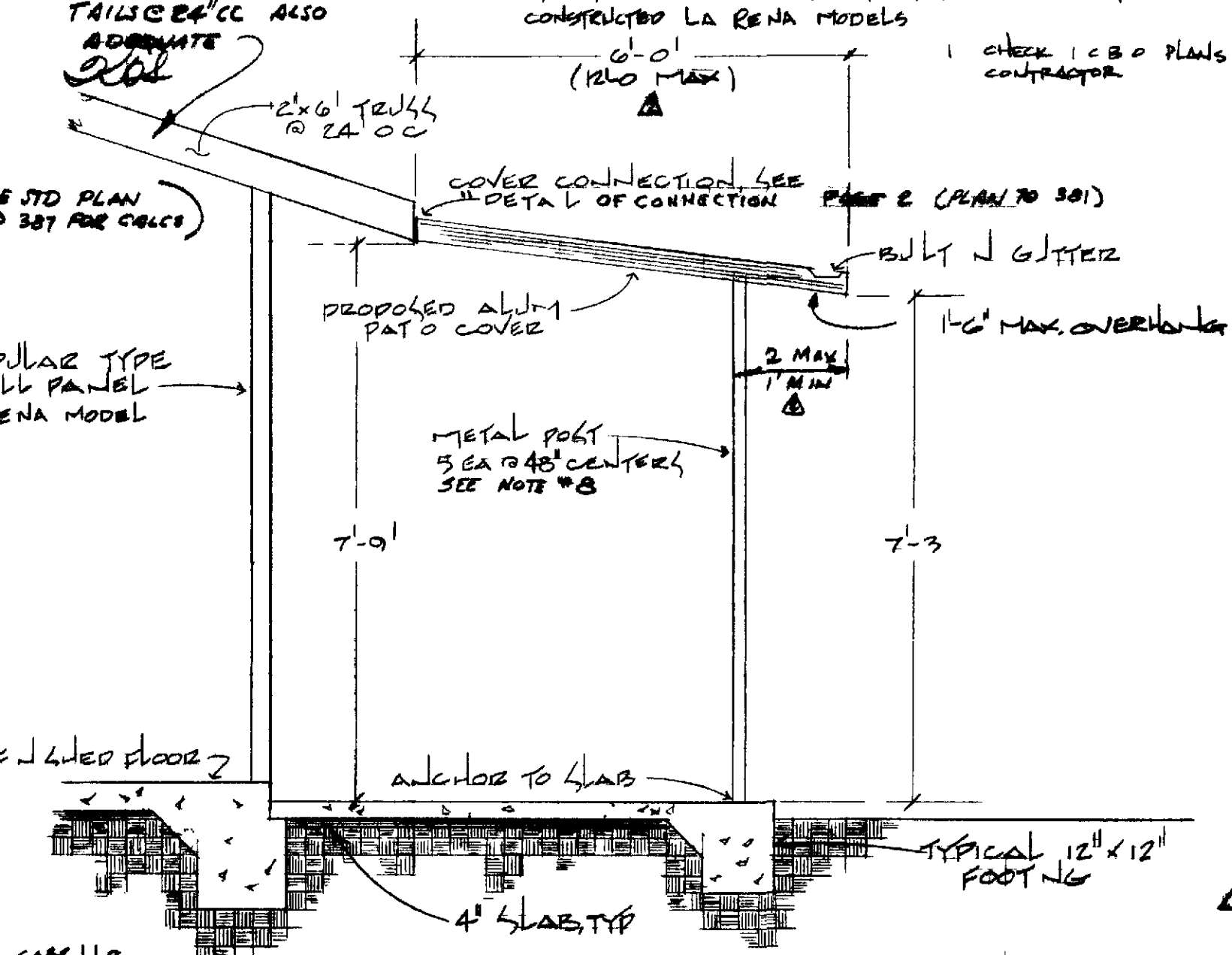

NOTE (LA REINA MODEL ONLY)
THIS PATIO COVER IS OPTIONAL IN THIS AREA & MUST BE LIMITED TO 6' x 7' MAX. SHORTER LENGTHS ACCEPTABLE. A FENCE IF EXISTING MUST BE REMOVED BEFORE PATIO CAN BE INSTALLED

NEW ALUM PATIO COVER APPROX 13' x 17' SEE NOTE 9



12-14-73 Deceased 2x38 of cover 301

LA REINA (R) ANDALUZ (R) CABRILLO (R) PATIO COVER (ALUMINUM) FRONT &/OR REAR	
LEISURE WORLD STANDARD PLAN NUMBER 126	
PROFESSIONAL COMMUNITY MGMT. INC. APPROVED <i>Jerry White</i>	
PCM INC POB 2220	380-4616 LAGUNA HILLS
MARCH, 75	